



HS-502A-HD Technical Data Sheet



www.conveyorguide.co.th



Pitch: 25.4mm Minimum Width: 150mm Open Area: 0% Approved: FDA Rod: Ø 5mm Flight: No Side Guard: No Curve: No	
--	--

Data

Belt Material	Belt Strength			Temperature		Belt Weight (Kg/M ²)
	Straight		Curve	°C (min.)	°C (max.)	
	Kg/M(BW)	N/M(BW)				
Polypropylene	2000	20000	--	1	100	5.4
Acetal	3500	35000	--	-40	80	8.3

BW – Belt Width

Color Table

Polypropylene					Polyethylene					Acetal					Nylon									
W	G	N	DB	B	W	G	N	DB	B	W	G	N	DB	B	W	G	N	DB	B					
●	●									●										●				

W-White, G-Gray, N-Nature, DB-Dark brown, B-Blue

Friction Table

Belt Material	Friction Wear strips & Products							
	UHMW	HDPE	Steel	Glass	SUS	Plastic	Cardboard	Aluminum
Polypropylene	0.32	0.24	0.15	0.09	0.13	0.08	0.15	0.25
Polyethylene	0.13	0.11	0.26	0.19	0.31	0.16	0.21	0.41
Acetal	0.11	0.09	0.27	0.16	0.26	0.15	0.19	0.28
Nylon	0.18	0.13	0.25	0.16	0.26	0.16	0.19	0.27

SUS – Stainless Steel

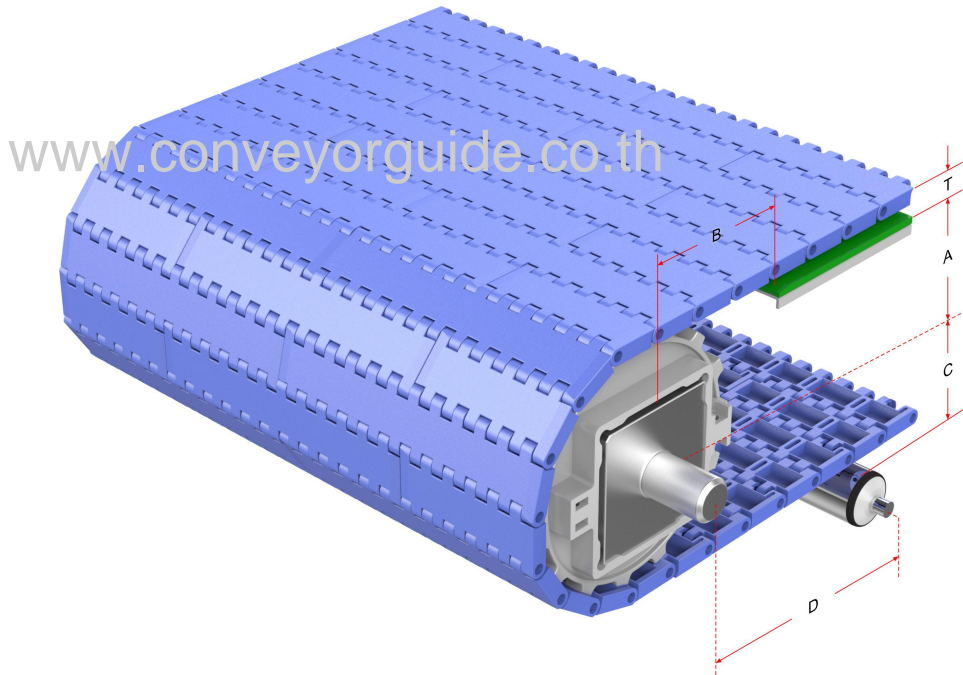

Conveyor Frame Dimensions					Unit : mm
No. Teeth	A (Min.)	B (Min.)	C (Max.)	D (Min.)	T
12	45	49	53	250	8.8
15	56	50	65	250	
18	69	73	77	250	
19	73	77	81	300	
24	91	80	100	300	

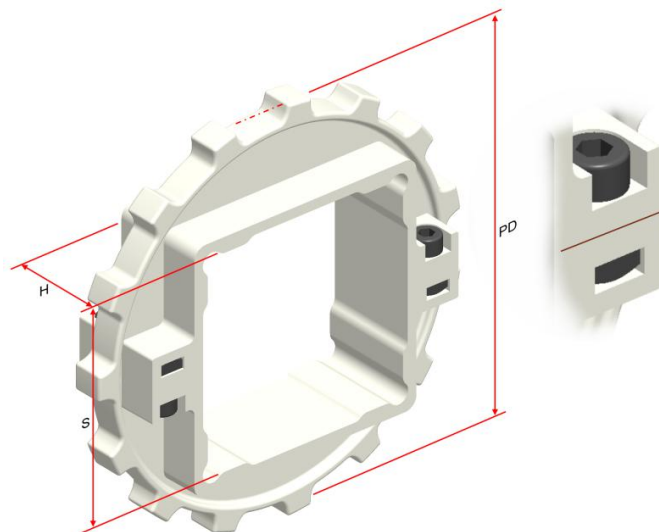



Sprocket Dimensions			Unit: mm		
No. Teeth	PD	S	D	H	K
12	98	38.5/40.5	25.4	25	--
15-Split	122	38.5/40.5/50.5/60.5/65.5	--	29	--
18-Split	146	60.5	50.8	35	--
18	146	40.5/60.5	45.5	25	--
19-Split	154	38.5/40.5/50.5/60.5/65.5	--	35	--
24-Split	194.6	60.5/65.5	--	52	--